



2.1.2 Channel Dolby Atmos Soundbar with Wireless Subwoofer



MODEL: MT-SB212DA

User Manual



Welcome

Premium connectivity that fuels modern lifestyle and empowers innovation.

A better everyday experience through amazing products.

The user manual will provide everything you need to know about using your new product.

All our products are produced and tested to stringent standards of performance and safety, and are pleased to provide a 2 Year Warranty with your purchase.

We hope you enjoy your purchase.



Contents

Welcome	2
Product Overview	4
Controls and Connections	11
Remote Control	16
Operation	19
Bluetooth®	21
Troubleshooting	23
Specifications	26
Compliance and Responsible Disposal	27

Product Overview

What's in the box:

- A. 2.1.2 Channel Dolby Atmos Soundbar
- B. Wireless Subwoofer
- C. Remote Control
- D. AAA Batteries (2)
- E. AC Power Cord
- F. Optical Cable
- G. Wall Mount Kit
- H. User Manual
- I. Warranty Certificate
- J. General Safety Warnings

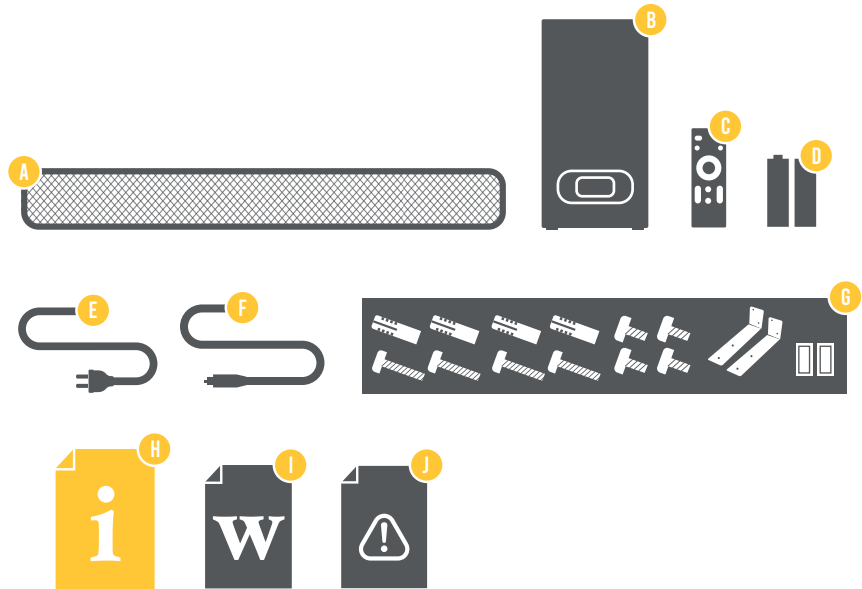

Wall Mount Kit

The illustration below shows the contents of the wall mount kit. These are the parts you will need when wall mounting the soundbar. Some parts are not shown at the same scale.

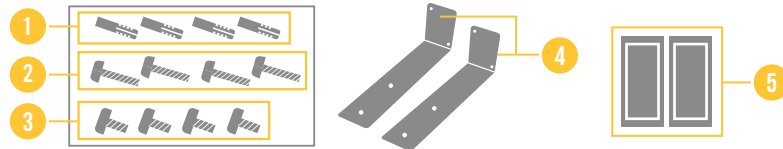

1. Plastic anchor (4)
2. Long screw (4)
3. Short screw (4)
4. Wall mount plate (2)
5. Sponge pad (2)

⚠ Important Tips

- Place the Soundbar on a level surface.
- Place the Soundbar away from any source that may generate heat or vibrations.
- Make sure there is enough space around the Soundbar for airflow.
- The remote control works up to 6 metres away from the Soundbar.
- Unplug the Soundbar before cleaning it.
- Clean using a dry cloth only - do not use water or chemicals.
- Use only the power supply provided.
- Keep liquid, children and pets away from the Soundbar at all times.

Installation - Free Standing

This soundbar can sit free-standing on a surface, or it can be mounted to a wall.

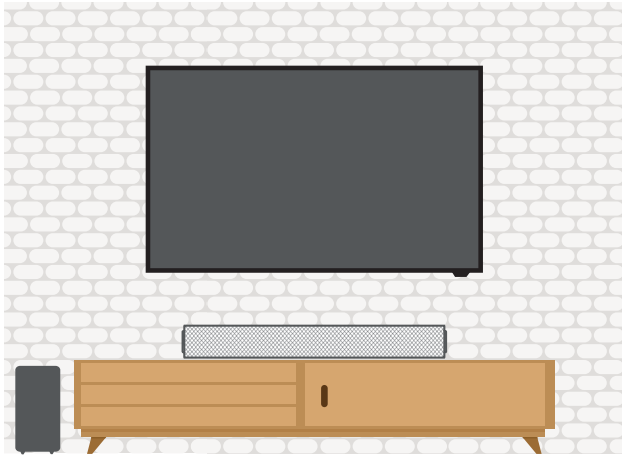

Free standing

Place on a secure, flat surface. Make sure the soundbar is standing on its rubber pads (on the left and right sides of the soundbar) and no other area of the bottom of the soundbar is touching the surface.

Installation - Wall Mounted



Wall mounted

Wall mounting instructions are on the following pages.

- **Wall mounted installation must be carried out by qualified personnel only. Incorrect assembly can result in severe personal injury and property damage! If you intend to install this product yourself, you must check for installations such as electrical wiring and plumbing, which may be hidden inside or behind the wall.**
- It is the installer's responsibility to verify and confirm that the wall will safely support the total load of the soundbar and wall brackets.
- Additional tools (not included) are required for the installation.
- Do not overtighten screws.
- If mounting on a wood stud wall, use an electronic stud finder to locate the centre of the framing studs before drilling and mounting.

Wall Mounting Instructions

1

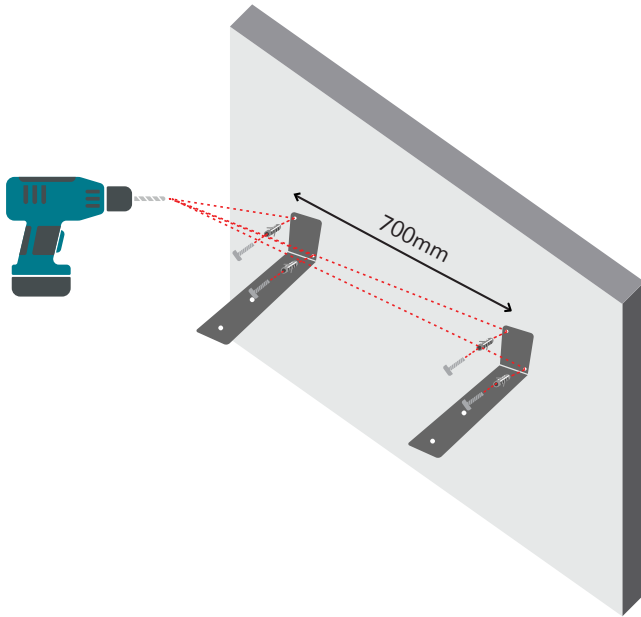

Use a pencil to make drill hole marks on the wall for the anchors. Make sure the marks are level before drilling. Use a 6mm bit and power drill (not supplied) to drill holes on the marks.

Insert plastic anchors into the holes and push in until they are flush with the wall. Drive the screws into the plastic anchors and tighten until the screw head is approximately 3mm from the wall.

2

Place the sponge pads on top of the mounting plates, with the holes aligned as pictured.

Insert screws through the holes and tighten.

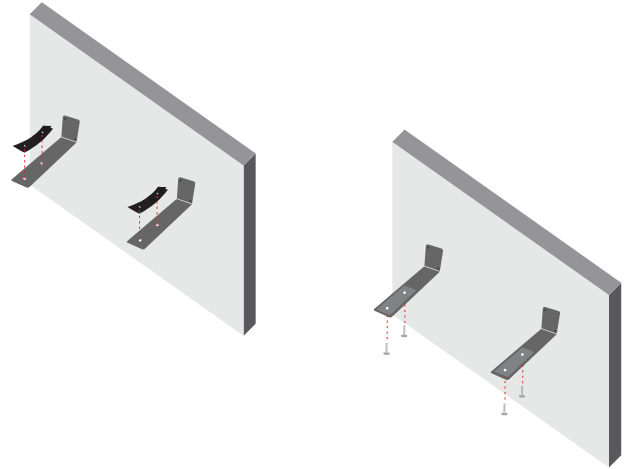

3

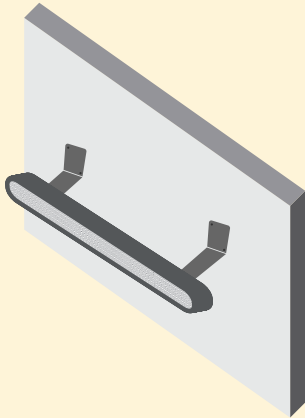

Mount the soundbar onto the mounting plates.

Note: there will be a gap between the soundbar and the mounting plate on the wall.

Connect to Power



Make sure the power switch is **switched off** at the power outlet until you have finished connecting your cables.



Rear view

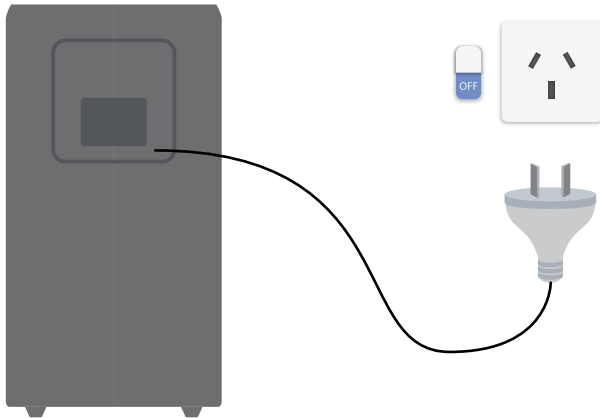

Don't forget to plug in the soundbar to the power outlet. Leave the power switched off until installation is finished.

Controls and Connections

Get to know your Soundbar

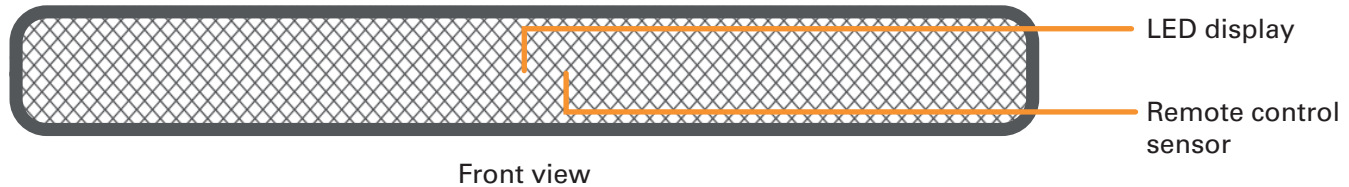

Buttons on the Soundbar

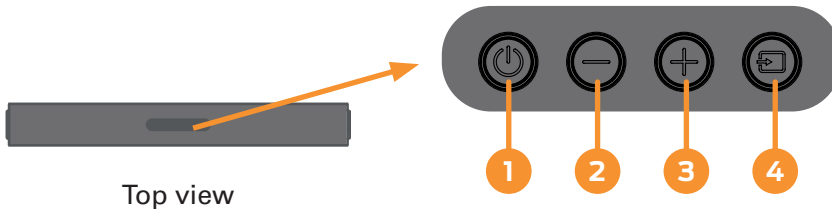







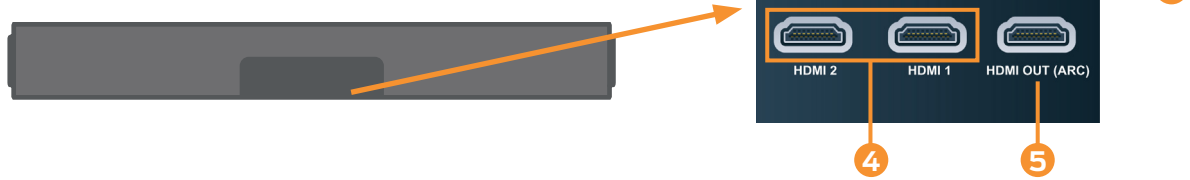



1. POWER: press to turn the soundbar on/off.
2. - button: press to decrease volume level.
3. + button: press to increase volume level.
4.  : press repeatedly to change between input sources.



Ports on the Soundbar

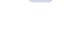

1	USB	 	STORAGE	Play your stored media files (supported file codecs and extensions may vary).
2	OPTICAL	 	SOUND	Connect an optical cable (included) to the OPTICAL OUT socket of your device (e.g. TV, DVD player) and the OPTICAL socket on the soundbar.
3	AUX IN	 	SOUND	Use a 3.5mm audio cable (not included) to connect the headphone socket of the connected audio device, such as a media player, to the AUX socket on the soundbar.
4	HDMI IN	 	SOUND PICTURE	Connect to a HDMI supported device like a DVD player or gaming console using a HDMI cable (not included). Audio will be played through the soundbar and picture will loop to the HDMI OUT (ARC) of the TV.
5	HDMI OUT (ARC)	 	SOUND	The ARC (Audio Return Channel) function allows you to send audio input from an ARC-compliant TV to an ARC-compliant audio device (e.g. soundbar) without the need for an additional audio cable connection



6	AC IN		POWER	Connect the AC power cord to the AC IN connector on the soundbar and the other end to a power source.
---	-------	---	-------	---

Rear Ports on the Soundbar

HDMI (ARC)

To use the ARC function, make sure the soundbar's TO TV (ARC) socket is connected via HDMI cable (not included) to the HDMI (ARC) socket of your ARC compliant TV. Then just use your TV remote control to adjust the volume output (VOL +/- and MUTE) of the connected audio device. In the TV settings menu, turn on the ARC and CEC function (when CEC is turned on, the sound bar will turn on/off automatically when the TV is turned on/off).



When you use ARC or Optical connection to your TV or DVD, the audio output in the TV or DVD settings menu must be set to PCM mode (instead of Auto mode, RAW mode or etc.).

Wireless Subwoofer

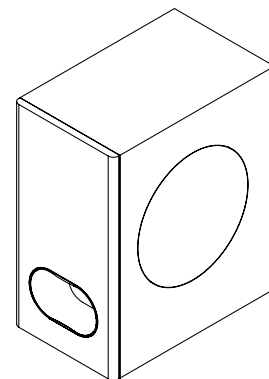
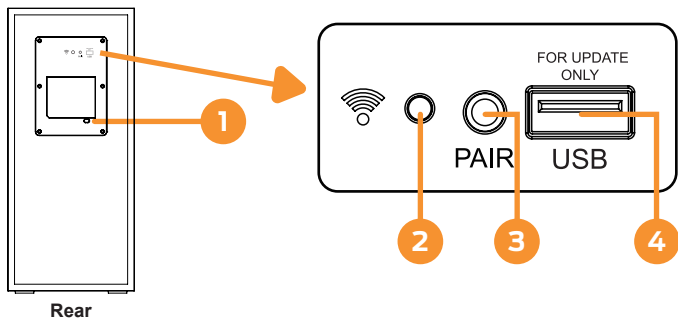

1. Power cord - connect to power the subwoofer.
2. LED Indicator - flashes blue slowly when searching to pair with the soundbar. Flashes blue quickly when pairing is successful, lights up blue. When on standby, lights up red.
3. Pair button - press to reset and manually pair again.
4. USB port - for software update only - **cannot be used for music playback.**

The wireless subwoofer will automatically pair with the soundbar when both the soundbar and subwoofer are connected to AC Power and when the soundbar is on Bluetooth mode.

Note: if the wireless subwoofer does not pair with the soundbar automatically, please refer to the next page on pairing manually.

Pairing the subwoofer to the soundbar manually

1. Connect both the soundbar and subwoofer to the AC power at the same time.
2. The LED indicator on the subwoofer will flash blue slowly. Press and hold the PAIR button to enter pairing mode, the LED indicator will flash blue quickly.
3. Press the  button on the soundbar or the remote control to turn on the soundbar. Press the INPUT button to select Bluetooth mode.
4. The LED indicator on the subwoofer will light up blue for 20-30 seconds. The subwoofer is now paired with the soundbar.



For best sound experience, place the subwoofer on the ground near the soundbar. The area of around the subwoofer should be clear of any obstructions.



- If the wireless connection fails again, check if there is conflict or strong interference (for example, interference from an electronic device) around your location. Remove these conflicts or strong interferences and repeat the above procedures.
- The subwoofer should be within 6m of the soundbar in an open area.



Remote Control

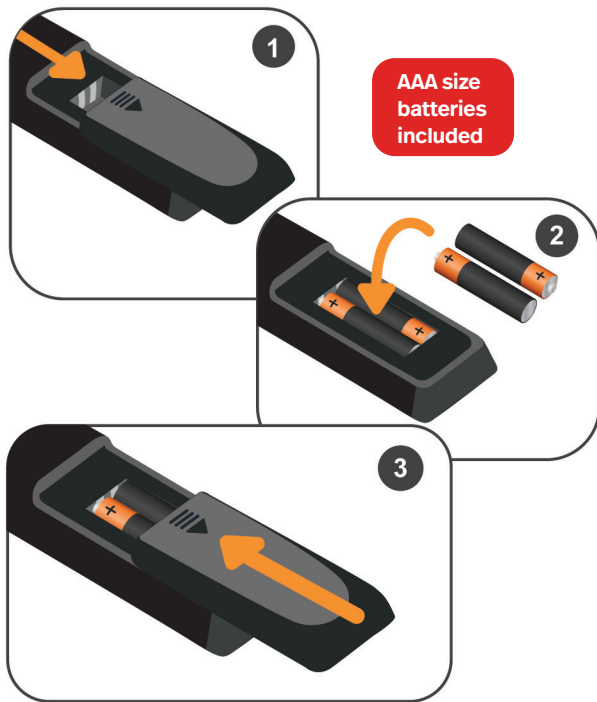

Illustration is for reference only.

Setup

Insert two AAA size batteries according to the polarity markings (+ / -) inside the compartment. Make sure the batteries are correctly aligned and properly pushed into place.



Precautions When Using Batteries

- Do not use old and new batteries together.
- Do not use different types of batteries (e.g. Manganese and Alkaline batteries) together.
- Remove the batteries from the remote if you do not intend to use it for a long time.
- When discarding used batteries, follow any guidelines for recycling and disposal of batteries that apply in your local area.
- Keep batteries away from children and pets.
- Never throw batteries into a fire or expose them to extreme heat.

Using the Remote Control

To use the remote, point it towards the remote sensor at the front of the soundbar. The remote will not operate if its path is blocked.

The remote has a range of up to about 6 metres from the soundbar at an angle of up to 30 degrees to either side of the sensor, as illustrated below.

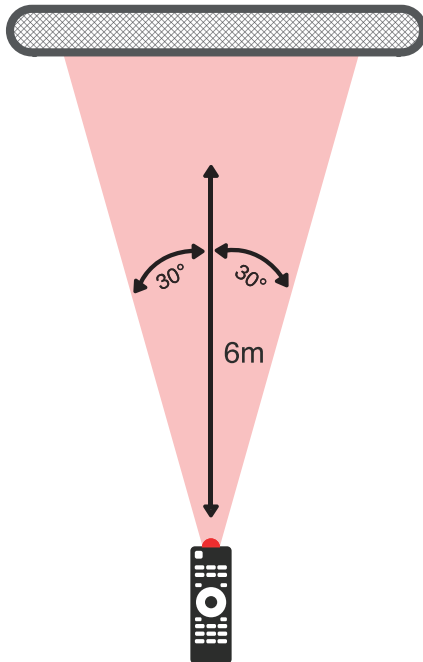

Remote Use

- Do not drop, step on or otherwise impact the remote control. This may damage the parts or lead to malfunction.
- Do not place objects between the remote control and the remote sensor.
- Do not use this remote control while simultaneously operating a remote control for other devices.

Remote Overview

POWER: Switch the soundbar to On or Standby

PAIR: Press and hold to connect or disconnect the Bluetooth device

VOL+ : Press to increase the volume level

⏮: Press to play the previous song (only for USB and Bluetooth mode)

VOL- : Press to decrease the volume level

MUSIC : Select the music EQ effect

TREB +/TREB - : Turn the treble up/down

3D : Turn 3D EQ effect on/off

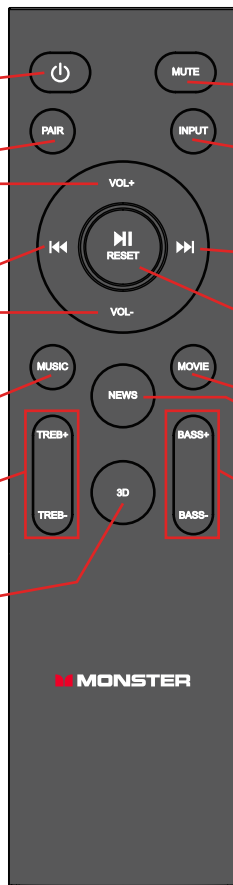

MUTE: Press to mute. Press again to unmute

INPUT : Press to change between input modes

▶▶: Press to play the next song (only for USB and Bluetooth mode)

⏸ / RESET : Press to play/pause (only for USB and Bluetooth mode). Press and hold to reset to factory default settings

MOVIE : Select the movie EQ effect

NEWS : Select the news EQ effect

BASS +/BASS - : Turn the bass up/down

Operation

General Operation

Function	Action
Turn the soundbar ON	Press the \cup button on the side of the soundbar, or press the \cup (POWER) button on the remote control to switch the soundbar on.
Turn the soundbar OFF	Press and hold the \cup button on the side of the soundbar, or press the \cup (POWER) button on the remote control to switch the soundbar off.
Change the input source/mode	When the soundbar is on, press the repeatedly or press the INPUT button on the remote or the \cup button on the side of the soundbar repeatedly to change the input source.
Increase/Decrease the volume	Press the + / - buttons on the soundbar or the VOL + / VOL - buttons on the remote control to adjust the volume level.

Input Modes

Mode	LED display
Standby	
HDMI (ARC)	ARC
HDMI 1	Hd 1
HDMI 2	Hd 2
Bluetooth	BLUE
Optical	OPTI
USB	USB
AUX IN	AUX



Dolby Atmos

Note: Your TV must support Dolby Atmos. If your TV does not support Dolby Atmos, you must connect a Dolby Atmos supported media player via the HDMI ports. You must use a HDMI 2.0 cable to connect.

- Ensure that “No encoding” is selected for bitstream in the digital audio output of the connected Dolby Atmos external device.
- When Dolby Atmos audio format is detected, the LED display on the soundbar will show Dolby Atmos.
- When Dolby Digital Plus audio format is detected, the LED display on the soundbar will show Dolby Surround.



- In Optical/HDMI/HDMI (ARC) mode, if there's no sound output from the soundbar and the LED display flashes, you may need to activate PCM or Dolby Digital Signal output on your external device.
- The soundbar may not be able to decode all digital audio formats from the input source. This will result in the soundbar muting. Ensure that the audio setting of the external device is set to PCM or Dolby Digital with the HDMI/Optical port on the soundbar.

Bluetooth®

You can listen to tracks from a media device if connected to the soundbar via Bluetooth® Wireless Technology.

Pairing Bluetooth® Devices

The first time you use your Bluetooth® device with the soundbar, you will need to pair them with one another.

Activate Bluetooth® on your compatible device, and set it to search for compatible devices.

Select the speaker name: 'MT-SB212DA' from the list of found devices.

Note: Only one playback soundbar can be connected to the speaker. If the speaker is already connected to another playback soundbar, the speaker will not appear in the Bluetooth® selection list. To disconnect the existing paired device, press and hold the PAIR button on the remote for 3 seconds.

If your device asks for a passkey (depending on the device manufacturers, model, and software version), then enter digits "0000" and press OK.



The operational range between this soundbar and a Bluetooth® device is approximately 10 metres (without any object between the Bluetooth® enabled device and the soundbar). Any obstacle between the devices can reduce the operational range.

Before you connect a Bluetooth® enabled device to this soundbar, ensure you know the device's capabilities. Compatibility with all Bluetooth® devices is not guaranteed.

If the signal strength is weak, your Bluetooth® receiver may disconnect, but it will re-enter pairing mode automatically.



If a mobile phone on which you are playing music receives a call, the music will be interrupted. The phone call audio however is not played via the speaker. Once you end the call, the devices are connected to each other again and playback resumes

Your device will also be disconnected when your device is moved beyond the operational range. If you want to reconnect your device, place it within the operational range.

If the connection is lost, follow the instructions (left) to pair your device to the player again.



Bluetooth® Playback

Function	Action
Increase the Volume	Press the + button on the soundbar or VOL + on the remote.
Decrease the Volume	Press the - button on the soundbar or VOL - on the remote.
Play/Pause	Press ►/RESET on the remote.
Skip/Rewind	Press ◀◀/▶▶ on the remote to skip/rewind tracks.
Un-pair a Bluetooth® device	Press and hold the PAIR button on the remote for 3 seconds.



Troubleshooting

If you encounter any problems with your product, please check this list of possible issues for a solution. If you don't find a solution here, contact After Sales Support on 1300 886 649.

Problem	Solution
No power	<ul style="list-style-type: none">• Ensure that the power is properly connected.• Ensure that there is power at the AC outlet.• Tap the ⏻ button on the soundbar or press the ⏻ button on the remote to turn the soundbar on.
Remote control does not work	<ul style="list-style-type: none">• Use the remote control closer to the soundbar. Aim directly at the sensor on the front of the soundbar• Insert the battery with its polarities (+/-) aligned as indicated. Please check the battery is installed correctly.• Replace the battery.
No response from the soundbar	<ul style="list-style-type: none">• Disconnect and reconnect the power, then turn the soundbar on again.
Soundbar not found in the Bluetooth device list when pairing	<ul style="list-style-type: none">• Ensure you have unpaired the previously paired Bluetooth device from the soundbar.• Ensure the Bluetooth function is activated on your Bluetooth enabled device.
General sound issues	<ul style="list-style-type: none">• Make sure the soundbar is connected to power and turned on (LED display on), and that it's set to the correct mode; use the INPUT button on the remote to change the input mode.• To check the system hasn't frozen, press the volume buttons; the number in the LED display should change accordingly.• If only a specific input mode is not working, it's likely the setting is wrong or the cable used is not working.
No sound from Netflix/other apps	<ul style="list-style-type: none">• Go to the TV settings menu, find Audio Output settings, and change the audio output mode to 'PCM' mode (instead of Auto, RAW, etc.)



Problem	Solution
No sound in HDMI 1 and/or 2	<ul style="list-style-type: none"> • The unit may not be able to decode all digital audio formats from the input source. In this case, the unit will mute. This is NOT a defect. Ensure that the audio setting of the external device is set to PCM or Dolby Digital. • Ensure that the input source is set to HDMI 1 or 2. The LED will display Hd1/Hd2. • Check that the HDMI cable is securely connected to the HDMI 1 / HDMI 2 ports.
No sound in USB mode	<ul style="list-style-type: none"> • Make sure the USB drive is in FAT32 file format, and it's no greater than 32GB;
No sound in HDMI ARC mode	<ul style="list-style-type: none"> • Make sure the input source is set to ARC; the LED will display 'ARC'. • Make sure your TV or external device supports ARC function and connect the HDMI cable to the ARC port of the TV or external device. • In the TV or external device setting menu, turn on the ARC function and the CEC function. • In the TV or external device setting menu, find the audio output settings and change the audio output mode to 'PCM' mode (instead of Auto, RAW, etc.) • Make sure both ends of the HDMI cable are fully plugged into the sockets. • If your TV or external device is muted or no sound output, press the mute button on your TV's remote control to unmute. • If none of these solutions work, try changing the HDMI cable.
No sound in Optical mode	<ul style="list-style-type: none"> • Make sure the input source is set to the correct mode; the LED will display 'OPTI'. • Increase the volume of the soundbar to make sure it's not muted. • For optical, make sure you remove the small caps on either end of the optical cable, and both ends are fully plugged into the sockets. • If none of these solutions work, try changing the optical cable.



Problem	Solution
No sound in BT mode	<ul style="list-style-type: none"> • Increase the volume of the soundbar to make sure it's not muted. Make sure Bluetooth is connected successfully - if not connected, the LED will flash 'bLUE'; once connected, the LED will display 'bLUE'. • Make sure the external Bluetooth device is playing normally and its volume is turned up.
No Dolby Atmos effect	<ul style="list-style-type: none"> • Ensure that the external audio source supports Dolby Atmos audio format. • Ensure that “no encoding” is selected for bitstream in the digital audio output of the connected Dolby Atmos external device. • Ensure that the top speaker is not covered.
No sound in AUX IN mode	<ul style="list-style-type: none"> • Make sure the LED screen is displaying 'AU'. Turn up the volume on the soundbar. • Turn up the volume on the external device and make sure it's not paused or muted. • Make sure the 3.5mm audio cable (not included) is properly plugged in at both ends.
No connection between the soundbar and the subwoofer	<ul style="list-style-type: none"> • If the connection indicator LED flashes blue, it indicates that the connection has failed. Turn the soundbar to standby mode and turn off the subwoofer. Wait 1 minute and reconnect both the soundbar and subwoofer to the AC power. • If the wireless connection fails again, check if there is conflict or strong interference (for example, interference from an electronic device) around your location. Remove these conflicts or strong interferences and repeat the above procedures. • Please pair the subwoofer manually.



For Technical and Warranty Support

1300 886 649

monster@tempo.org

monsterproducts.com.au

Distributed by Tempo (Aust) Pty Ltd,

PO Box 132, Frenchs Forest NSW 1640

Specifications

Soundbar - AC Input	AC 110-240V, 50/60Hz
Subwoofer - AC input	AC 110-240V, 50/60Hz
Power consumption	Soundbar: 96W Subwoofer: 96W
Power output (RMS)	Soundbar: 2 x 30W + 2 x 20W Subwoofer: 80W
Bluetooth pairing operation range	Up to 10 metres
Bluetooth pairing name	MT-SB212DA
Bluetooth pairing password	0000
Bluetooth version	5.0
Remote control operation range	Up to 10 metres
Dimensions (W x H x D)	960 x 81 x 106mm (Soundbar) 190 x 370 x 308 (Subwoofer)
Net weight	Soundbar: 3.9 kg (approx.) Subwoofer: 4.45 kg (approx.)

Compliance and Responsible Disposal



Packaging

The packaging of your product has been selected from environmentally friendly materials and can usually be recycled. Please ensure these are disposed of correctly. Plastic wrapping can be a suffocation hazard for babies and young children, please ensure all packaging materials are out of reach and are safely disposed of. Please recycle these materials rather than throwing them away.

Product

At the end of its working life, do not throw this product out with your household rubbish. An environmentally friendly method of disposal will ensure that valuable raw materials can be recycled. Electrical and electronic items contain materials and substances which, if handled or disposed of incorrectly, could potentially be hazardous to the environment and human health.

Compliance

This product complies with the Australian Safety Standard AS/NZS 62368.1 to ensure the safety of the product.

Bluetooth®

The Bluetooth® word mark and logos are registered trademarks owned by Bluetooth SIG, Inc., and any use of such marks by Hands (IP) Holdings Pty Ltd is under license. Other trademarks and trade names are those of their respective owners.

Dolby

Dolby, Dolby Audio, and the double-D symbol are trademarks of Dolby Laboratories Licensing Corporation. Manufactured under license from Dolby Laboratories. Confidential unpublished works.

Copyright © 1992-2021 Dolby Laboratories. All rights reserved.



 **MONSTER**®
Always Lead. Never Follow.™